

АВТОМАТИЧЕСКАЯ И ПОСТОЯННАЯ

Grain Driers Electric Drive c/w PLC

1

2

3

4

5

6

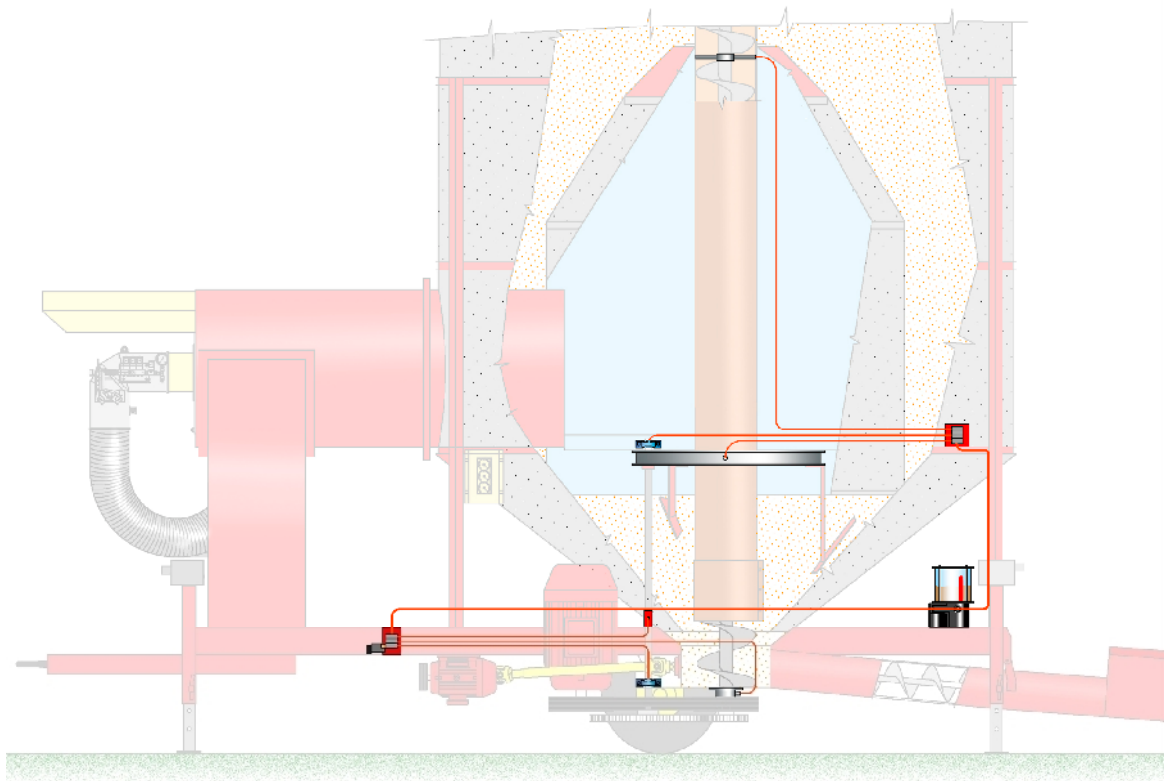

FRATELLI PEDROTTI s.r.l.

MACCHINE PER L' AGRICOLTURA

Via Zanardelli 12/a

25030 **MAIRANO**

BRESCIA - ITALY

Tel: 0309975210 - 0309975119

Telefax: 0309975220

E-Mail: info@pedrottisrl.it

Internet: www.pedrottisrl.it

"PEDROTTI" drier

(. . .)

(. . . 1):

- 1
- 2
- 3
- 4

()

- 1 - 4:
- 2 - 3:

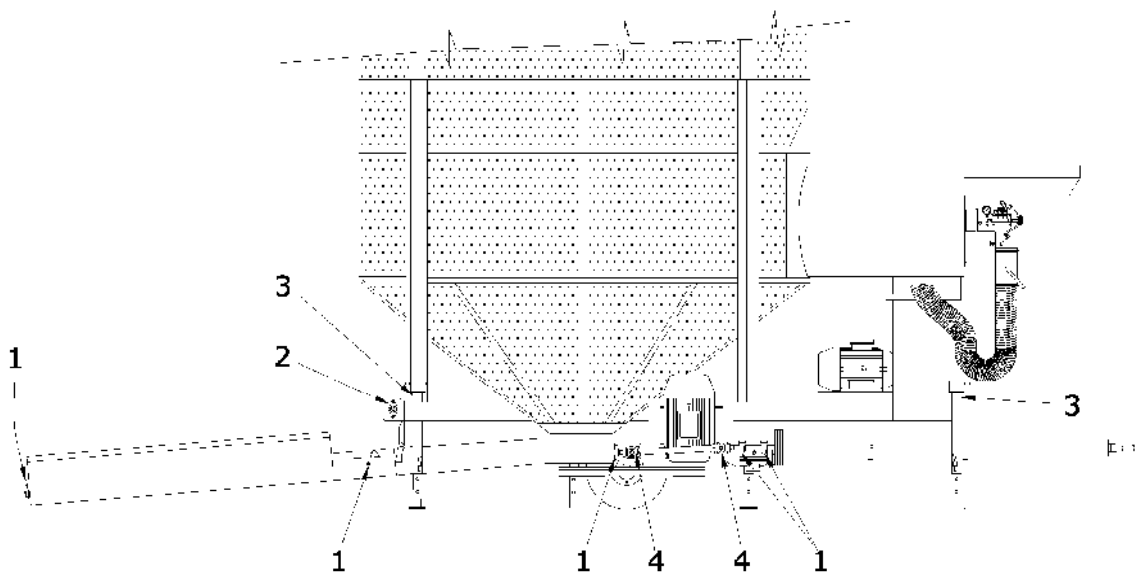

.1

LISTING AND DESCRIPTION OF COMPONENTS

- 1 Electro pump powered 24 V AC, version "with TIMER PAUSE-SENSOR"
- 2 Grease reservoir of 4 Kg, working autonomy 600 hours approx.
- 3 Grease scraper
- 3 Filling grease
- 3.1 Filling grease complete c/w filter
- 6 Magnetic sensor "grease gone through"
- 7 Grease entering 1° block B
- 8 Grease entering 2° block C
- 9 Sensor connector
- 10 Grease pipes in copper or PVC
- 11 -18 Grease exits to the greasing points.

- A Connector for electric supply from the electric control panel of the drier.
- B 1° Block of dosers/distributors
- C 2° Block of dosers/distributors
- D Connettor of Minimum Level Switch to electric control panel

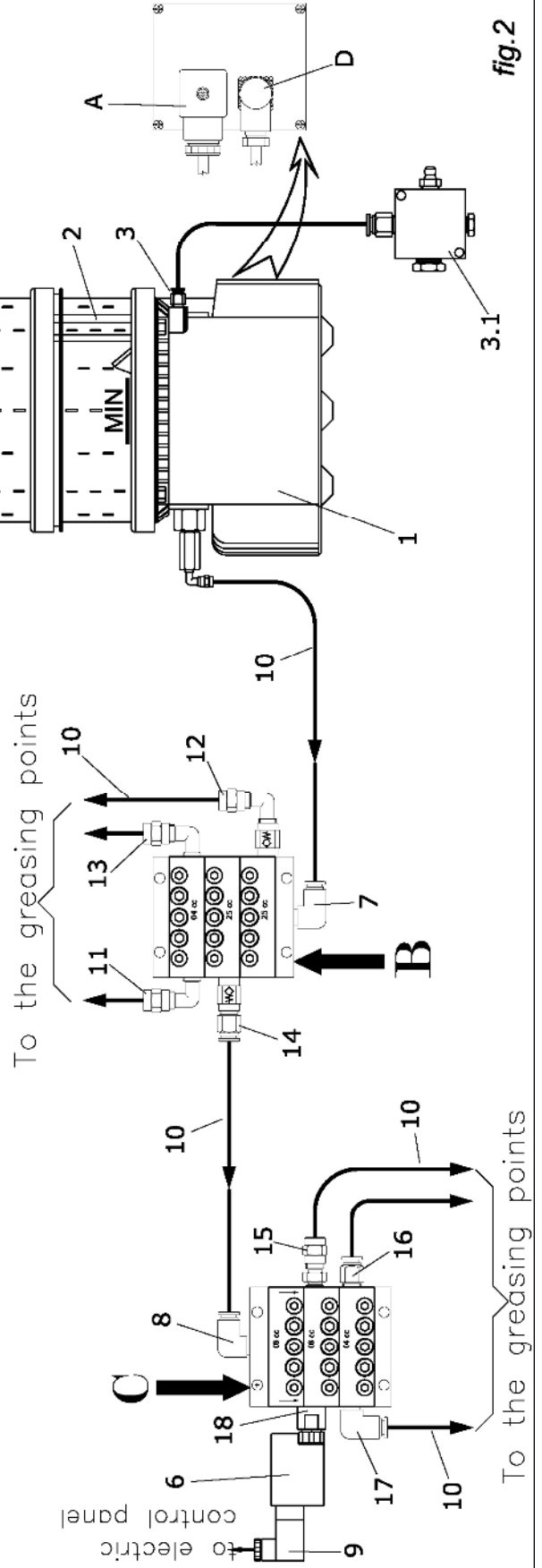

fig.2

3

1

2

(10) , , (6).

3

30 - 40

4

10
Junior/Super.

Large XL 15

5

2,8 3/

50

250

6



7.3

2a.

(1, 2)

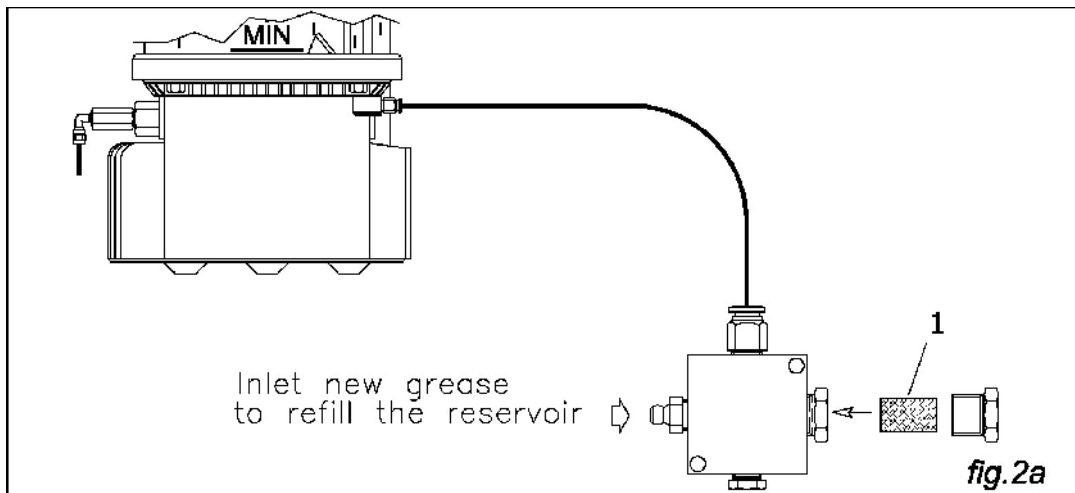

4

(B), (7). (3)

- .11 N° 1 04 cc:
- .12 N° 1 25 cc:
- .13 N° 1 04 cc:
- .14 N 1 25 cc:

(C), (8).

- .15 N° 1 (C) 08 cc:
- .16 N° 1 04 cc:
- .17 N° 1 04 cc:
- .18 " "

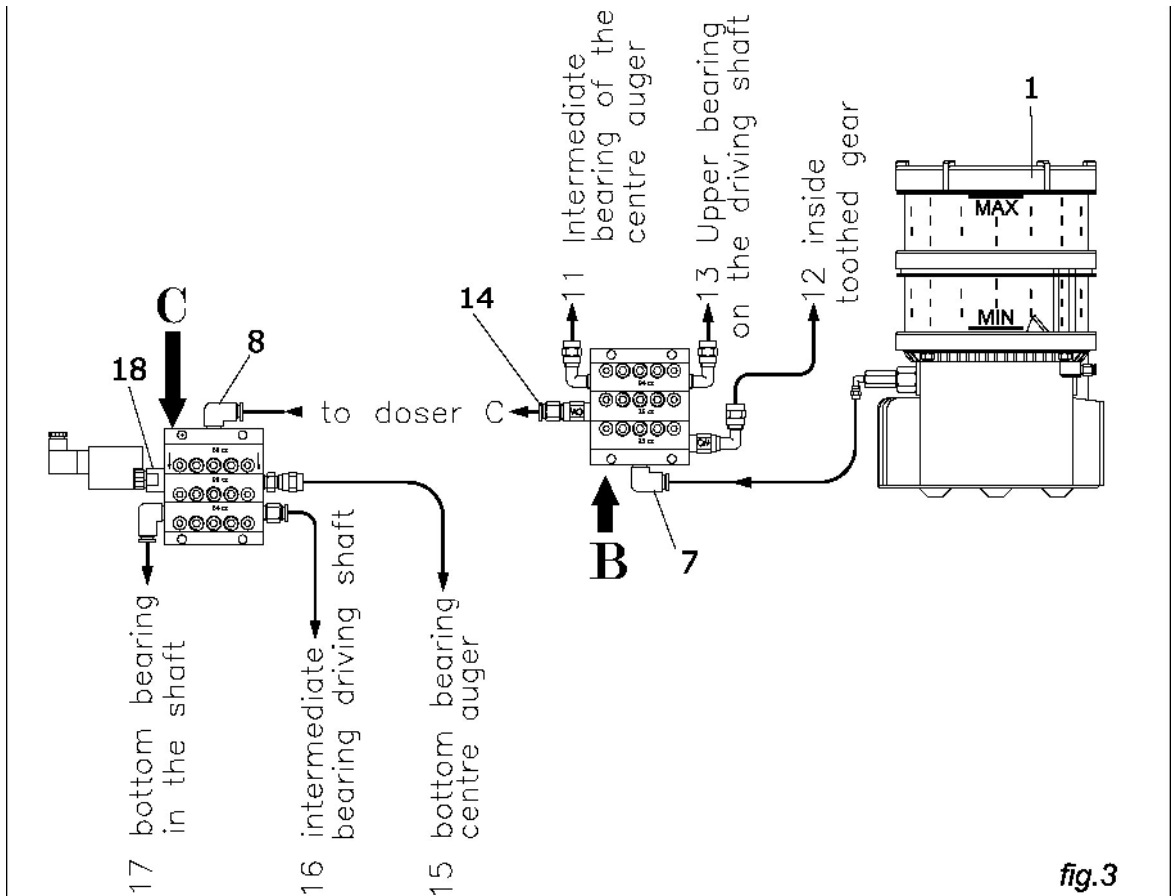

3

10

(1)

(2)

()

1

(Large 10 XL

15 Junior/Super)

2

3

(2)

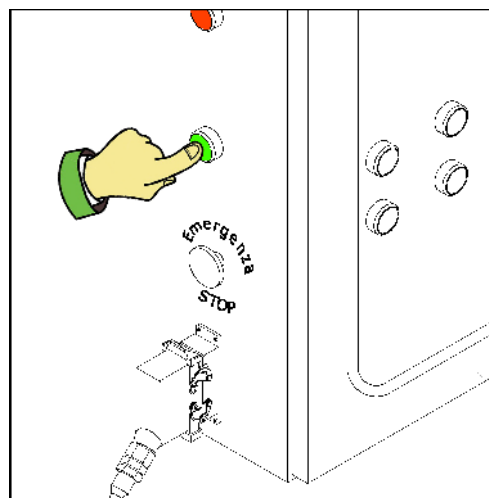
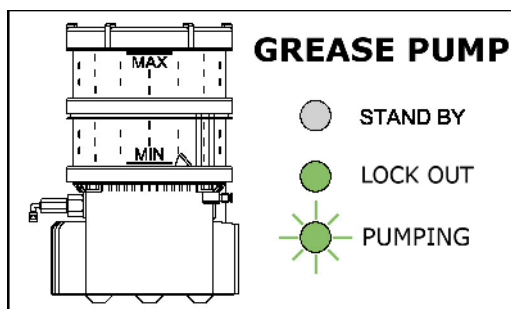

8

()

1

1.1 – (. . . 4)

1 –

2 – (24 VAC () 1 2

(RPG).

1.2

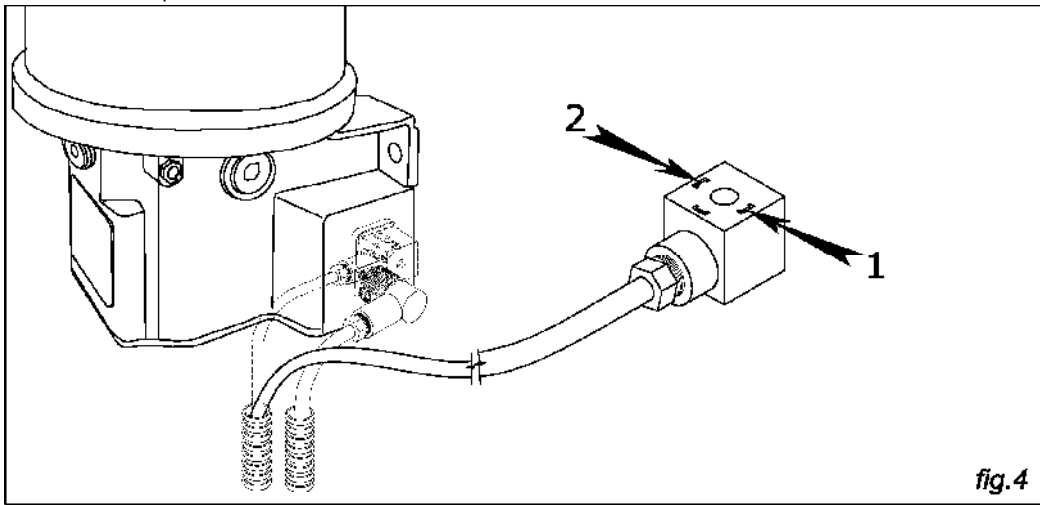

1.2 –

(. . . 5)

+ 3G

1.

2.

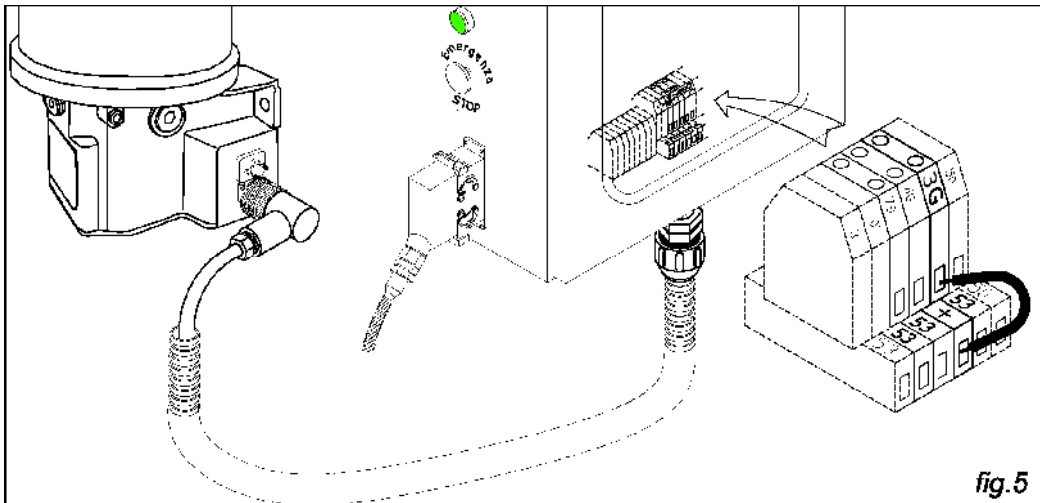

1.3 – (. . 6)

1

+ 4G,

2

(6.1),

6

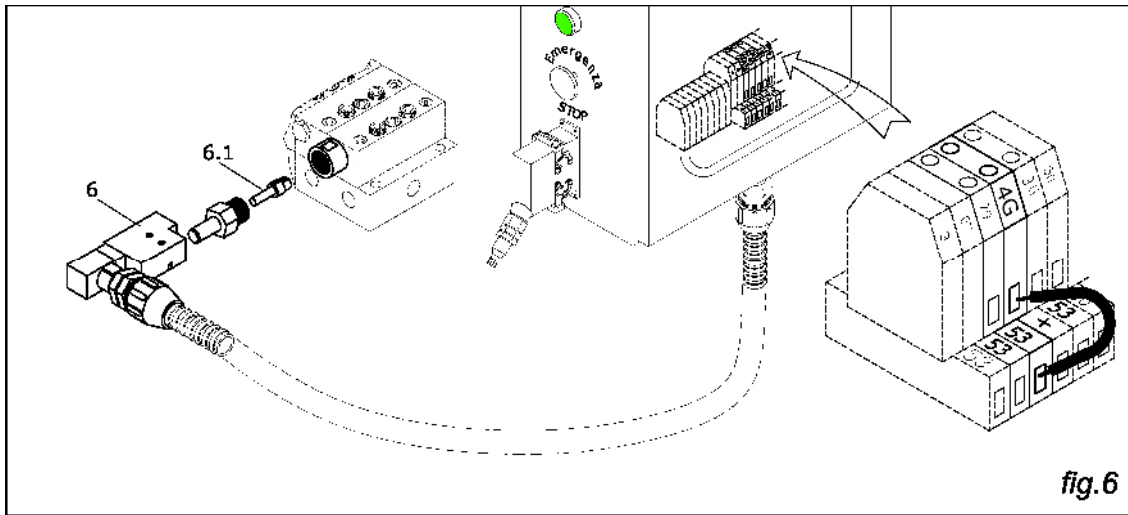

fig.6

2

2.1–

(B) (. 7)

n° 7

(5).

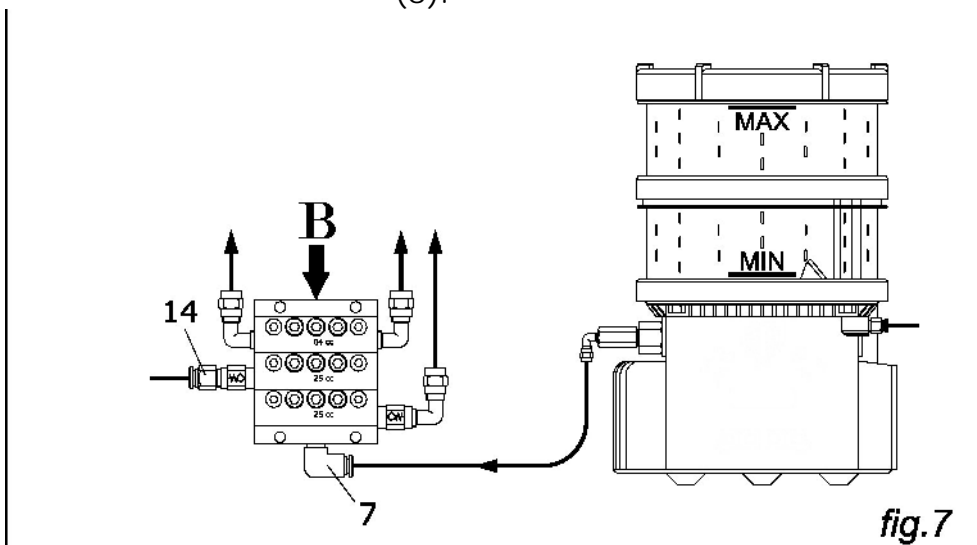

fig.7

2.2 –

(B) (. 7)

(14)

“B”

(. . 8).

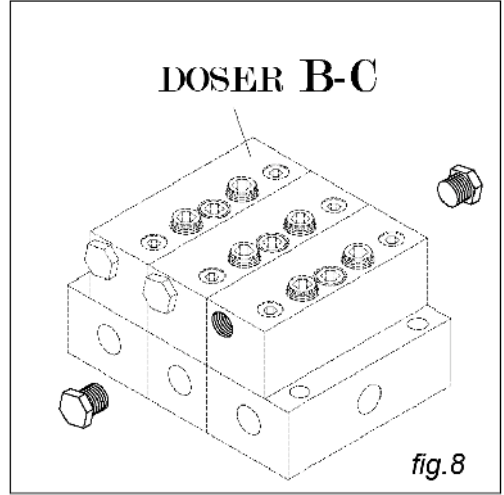

(B),

(C)

(8)

M10x1, 14.1 . 9

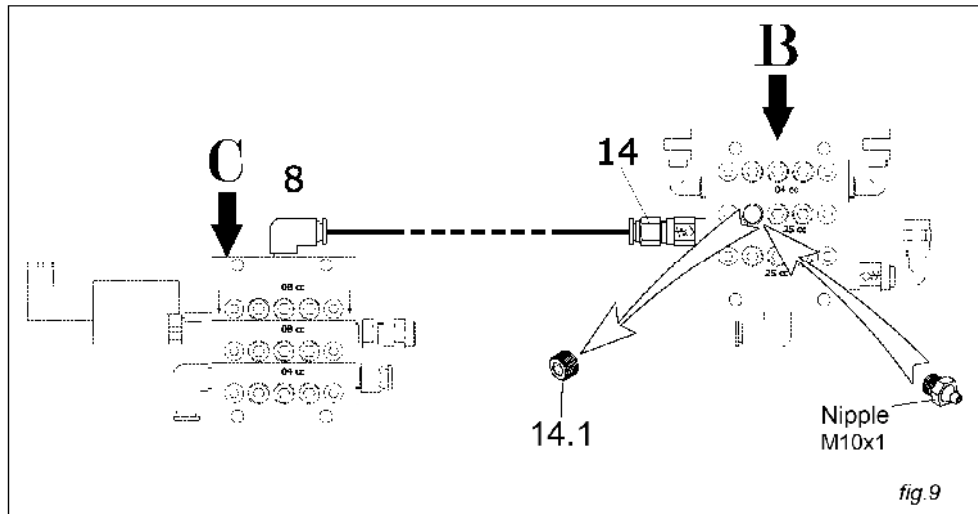

3 -

()

3.1

(5)

(7)

3.2

10 11

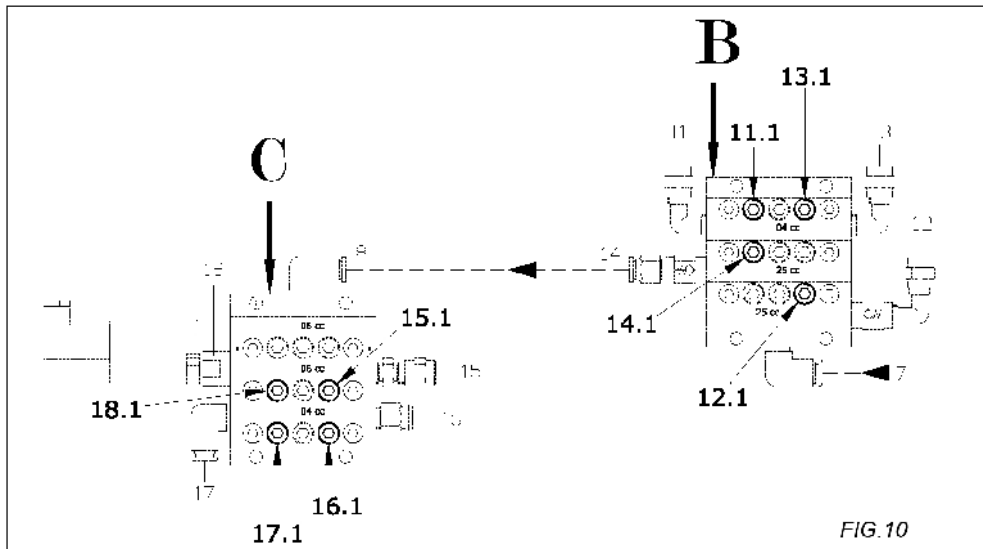

FIG. 10

(. . . 11):

12.1

(12 (B)),

M10x1:

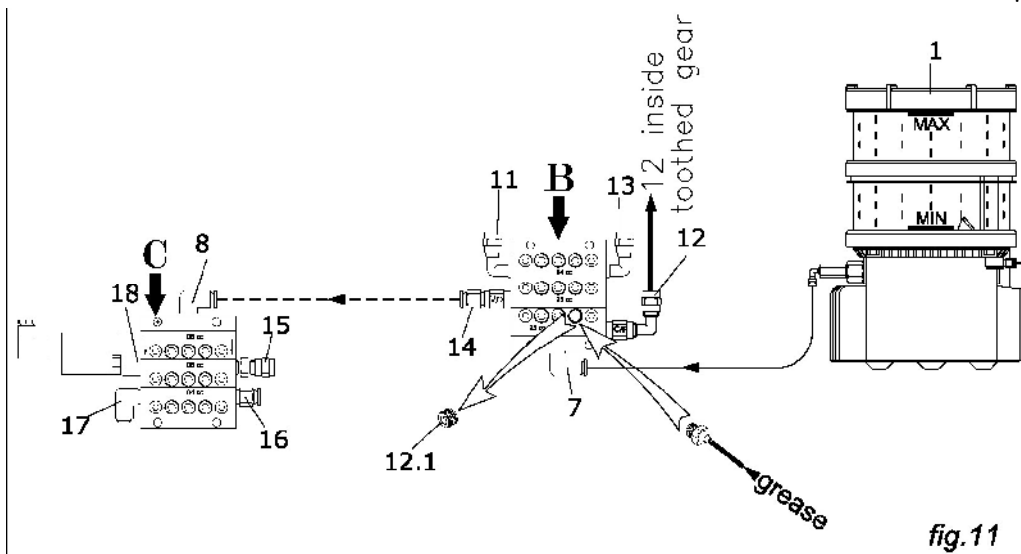
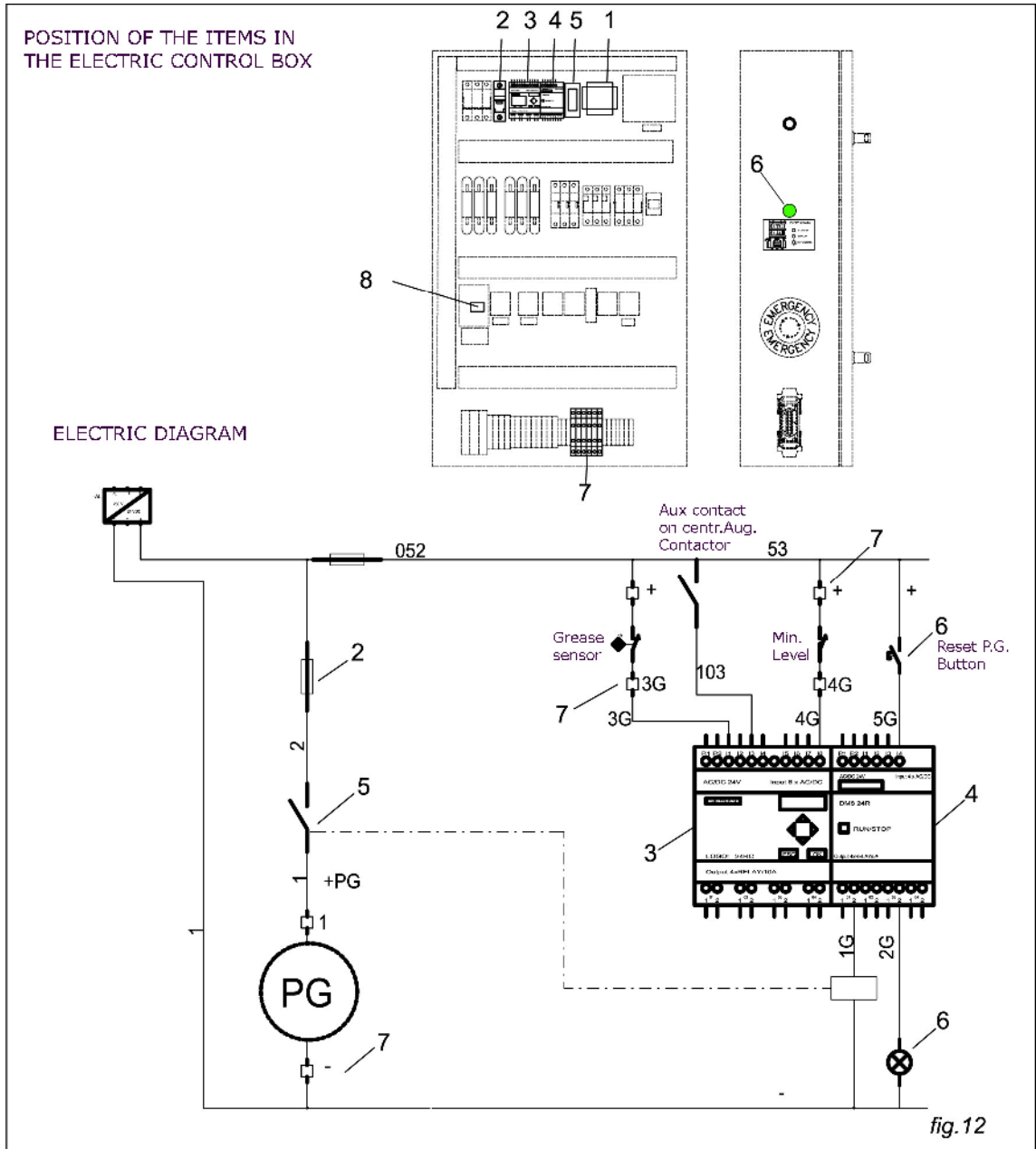

fig. 11

24 AC « »

(.12).



- 1
- 2
- 3
- 4
- 5
- 6
- 7

"LOGO".

24 AC.

(.2)

1. , 24VAC, « 600 ».
2. 4 , .
3. 3.1 .
- 6.
7. 1
8. 2
- 9.
- 10.
- 11-18. \
- .
- .
- .
- D.